

# FRM2A

# FREIGHTLINER

Rear suspension package

## INSTALLATION INSTRUCTIONS

- With vehicle unloaded & full air pressure measure 5" from the Timbren frame bracket to axle pad.
- When positioning frame bracket ensure that the Aeon spring rests over center of axle pad.
- Drill holes for Timbren bracket providing for at least four 5/8" Gr.5 bolts through the bracket & frame.
- Bolt frame bracket to frame using existing holes where possible.
- Assemble Aeon spring to bracket as shown in adjacent diagram.
- Weld Timbren lower assembly to axle.

### NOTES:

OEM U-Bolt axle pad may have raised bump stop extension. Carefully remove this extension if it interferes with positioning of item # 8.

### SAFETY CAUTIONS

Ensure sufficient clearance between frame bracket & tire.  
Always refer to and follow the vehicle manufacturer's guidelines when welding or drilling during installation of this kit.

### OVERLOAD PREVENTION:

A working height less than 2" results in overload condition of item 5. If this condition exists during operation of vehicle, customer supplied mechanical stop to limit suspension travel must be used.

*Do not exceed vehicle manufacturer's recommended axle weight rating. Check for AEON® interference with vehicle components - Under load AEON® will "expand" in diameter.*

**Ref.** = Reference  
**Part** = Part #.  
**Qty.** = Quantity

Ref	Part	Qty
1	K10257-003	1L-1R
2	F11102-150	4
3	F11146-150	8
4	F40053-020	4
5	A00200-75V0B	2
6	F40071-020	8
7	F31007-150	8
8	K51265-005	2

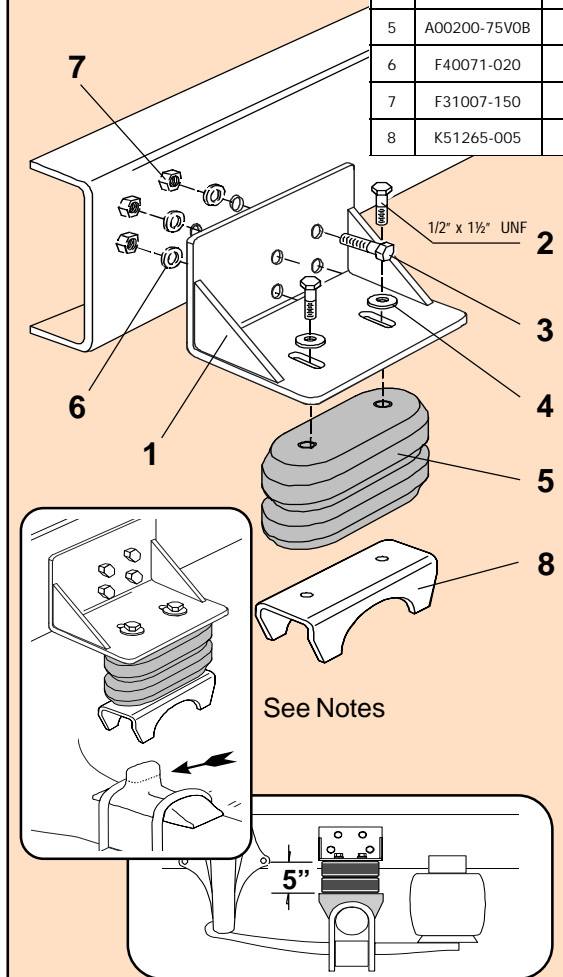

FRM2A



## FRM2A

PART NUMBER	DESCRIPTION	QTY	LOCATION
F31007-150	NYLOCK LOCKNUT 5/8 UNF GR 5 Z	8	H2E
F40071-020	WASHER FLAT USS 5/8 x 1-3/4 GR 2 Z	8	H2E
F11146-150	HCS 5/8 x 2-1/2 UNF GR 5 Z	8	H2E
F40053-020	WASHER FLAT 1/2 x 1-1/2 GR 2 Z	4	G4A
F11102-150	HCS 1/2 x 1-1/2 UNF GR 5 Z	4	G1D
A00200-75V0B	HOLLOW RUBBER SPRING	2	C16B
K10257LH-003	FRFL106 / FRM2A WELDMENT LH PTD.	1	D8C
K10257RH-003	FRFL106 / FRM2A WELDMENT RH PTD.	1	D8C
K51265-005	CHANNEL 1/4 x 3 x 8 - PAINTED	2	D8C
B90223	10-3/4 x 9-1/2 x 7 DW Carton	1	A1A
B10100	NEWSPRINT 18" ROLL	1	
B00029-010	BARCODE LABEL FOR KIT	1	

### ASSEMBLY NOTES:

APPLY 'LEFT' LABEL TO L/H BRACKET.

### Clearance Instructions:

Rear SES Kits for Pick-Ups and Vans should have a 1/2" to 1-1/2" gap between the rubber spring and contact point when empty.

A partial load, or vehicle accessories will reduce or eliminate the gap.

Front SES kits are usually in full contact.

Medium and Heavy-Duty Trucks, Trailers and Motorhomes will be in constant contact, and have no gap.