

# HIR338

# HINO

## Rear suspension package

### INSTALLATION INSTRUCTIONS

- Raise vehicle allowing the axle to hang freely.
- Remove existing bump stop assembly.
- Assemble Aeon rubber spring and bracket as shown in the adjacent diagram.
- Mount Timbren assembly to axle using Timbren supplied fasteners as shown in the adjacent diagram.
- Lower vehicle.

#### NOTES:

Check that brake line or brake cable locations do not interfere with Aeon spring bracket.

Do not exceed vehicle manufacturer's recommended axle weight rating. Check for AEON® interference with vehicle components - Under load AEON® will "expand" in diameter.

Ref. = Reference  
Part = Part #.  
Qty. = Quantity

Ref	Part	Qty
1	F11064-250	4
2	A00200-65Q30	2
3	K10398-003	1
4	F11077-280	3
5	F11078-286	1
6	F40031-020	4
7	F31003-250	4
8	K10397-003	1

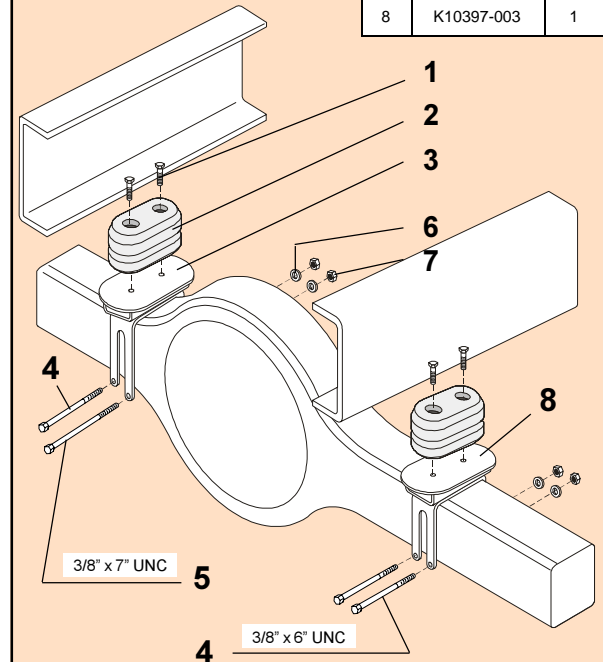

## HIR338

PART NUMBER	DESCRIPTION	QTY	LOCATION
F31003-250	NYLOCK LOCKNUT 3/8 UNC GR 5 Z	4	G1B
F40031-020	WASHER FLAT USS 3/8 x 1 GR 2 Z	4	G1C
F11064-250	HCS 3/8 x 1-3/4 UNC GR 5 Z	4	G3D
F11077-286	HCS 3/8 x 6 UNC GR 8 ZD	3	G3B
F11078-286	HCS 3/8 x 7 UNC GR 8 ZD	1	G3B
A00200-65Q30	Hollow Rubber Spring	2	C17B
K10398-003	HIR338 WELDMENT - PAINTED	1	D21F
K10397-003	HIR338 WELDMENT - PAINTED	1	D21F
B90223	10-3/4 x 9-1/2 x 7 DW Carton	1	A1A
B10100	NEWSPRINT 18" ROLL	1	
B00029-010	BARCODE LABEL FOR KIT	1	

### ASSEMBLY NOTES:

APPLY 'LEFT' LABEL TO K10398 BRACKET.

### Clearance Instructions:

Rear SES Kits for Pick-Ups and Vans should have a 1/2" to 1-1/2" gap between the rubber spring and contact point when empty.

A partial load, or vehicle accessories will reduce or eliminate the gap.

Front SES kits are usually in full contact.

Medium and Heavy-Duty Trucks, Trailers and Motorhomes will be in constant contact, and have no gap.