

HIRFA

HINO

Rear suspension package

INSTALLATION INSTRUCTIONS

- a) Raise vehicle allowing the axle to hang freely.
- b) Assemble Aeon rubber spring and bracket as shown in the adjacent diagram.
- c) Position Timbren bracket on frame centered over leaf spring or axle & drill 2 holes (17/32"OD) using frame bracket as template.
- d) Mount Timbren assembly and shock bracket using Timbren supplied fasteners.
- e) Lower vehicle.

Do not exceed vehicle manufacturer's recommended axle weight rating. Check for AEON® interference with vehicle components - Under load AEON® will "expand" in diameter.

Ref. = Reference
Part = Part #.
Qty. = Quantity

Ref	Part	Qty
1	F12103-253	2
2	F31005-150	4
3	K51177-003	1L-1R
4	F11103-150	4
5	F40052-020	4
6	A1610B-003	2
7	A00540-65E60	2
8	F31005-250	2

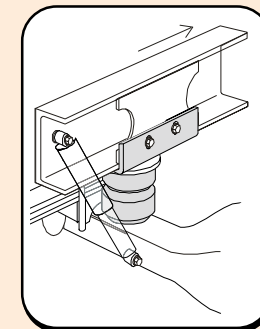
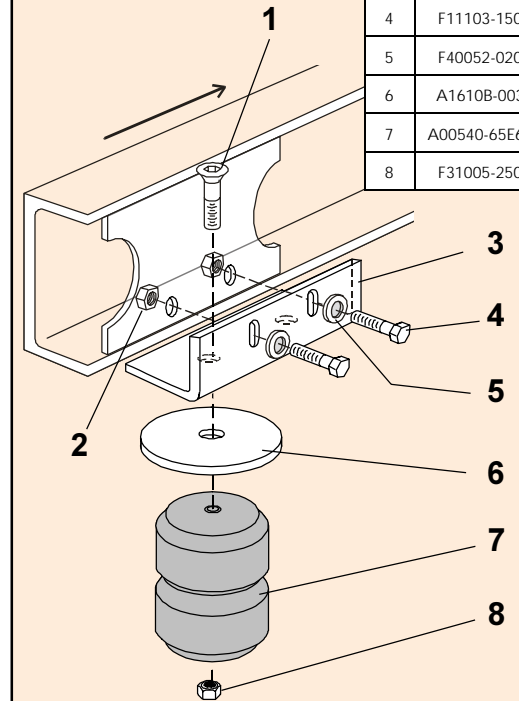

HIRFA



HIRFA

PART NUMBER	DESCRIPTION	QTY	LOCATION
F31005-150	NYLOCK LOCKNUT 1/2 UNF GR 5 Z	4	G1D
F40052-020	WASHER FLAT USS 1/2 x 1-3/8 GR 2 Z	4	G1D
F11103-150	HCS 1/2 x 1-3/4 UNF GR 5 Z	4	G1D
F31005-250	NYLOCK LOCKNUT 1/2 UNC GR 5 Z	2	G1B
F12103-253	FHSCS 1/2 x 1-3/4 UNC GR 5 B	2	J2C
A00540-65E60	Hollow Rubber Spring	2	C8B
K51177LH-003	FORMED PLATE 1/4 x 4-7/16 x 8 PAINTED	1	E1D
K51177RH-003	FORMED PLATE 1/4 x 4-7/16 x 8 PAINTED	1	E1D
A1610B-003	WASHER 4-1/2 OD x 17/32 ID x 1/4 THK PTD.	2	D20A
B90201-CR	LARGE REAR BOX - 10.5 x 8.5 x 6	1	A--D
B10000	8" x 12" BUBBLE FOR KITS	1	
B00029-010	BARCODE LABEL FOR KIT	1	

ASSEMBLY NOTES:

APPLY 'LEFT' LABEL TO L/H BRACKET.

Issued: 11/8/2005

Clearance Instructions:

Rear SES Kits for Pick-Ups and Vans should have a 1/2" to 1-1/2" gap between the rubber spring and contact point when empty.

A partial load, or vehicle accessories will reduce or eliminate the gap.

Front SES kits are usually in full contact.

Medium and Heavy-Duty Trucks, Trailers and Motorhomes will be in constant contact, and have no gap.