

PF357

PETERBILT

Front suspension package

INSTALLATION INSTRUCTIONS

- a) Raise vehicle allowing the axle to hang freely.
- b) Remove top shock mounting bolts.
- c) Assemble Aeon rubber spring and bracket as shown in the adjacent diagram.
- d) Insert Timbren assembly between frame and upper shock bracket.
- e) Using hole(s) in bracket as template, drill 5/8" diameter hole(s).
- f) Tighten using Timbren fasteners provided - torque to OEM specifications.
- g) Lower vehicle.

SAFETY CAUTIONS

Always refer to and follow the vehicle manufacturer's guidelines when welding or drilling during installation of this kit.

Do not exceed vehicle manufacturer's recommended axle weight rating. Check for AEON® interference with vehicle components - Under load AEON® will "expand" in diameter.

Ref. = Reference
Part = Part #.
Qty. = Quantity

Ref	Part	Qty
1	F11142-150	2
2	F40071-020	2
3	F31007-150	2
4	K10405-003	2
5	A00560-75C70	2
6	F11104-150	2

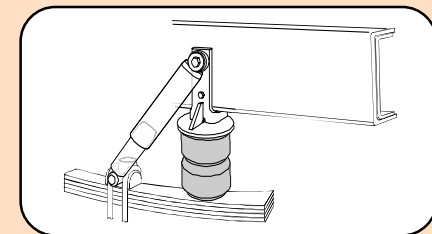
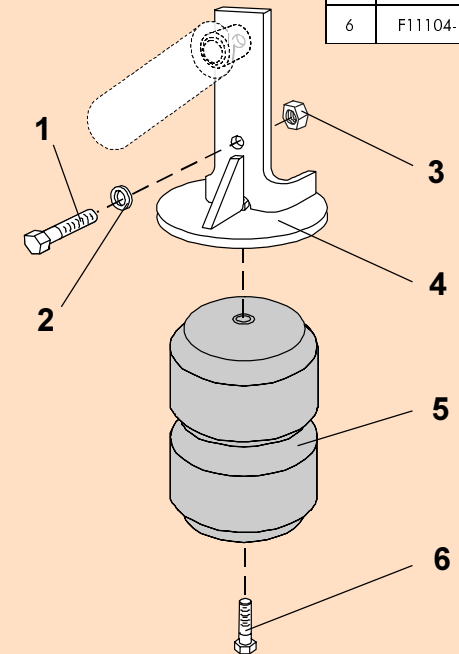

PF357

PART NUMBER	DESCRIPTION	QTY	LOCATION
F31007-150	NYLOCK LOCKNUT 5/8 UNF GR 5 Z	2	H2E
F40071-020	WASHER FLAT USS 5/8 x 1-3/4 GR 2 Z	2	H2E
F11142-150	HCS 5/8 x 1-1/2 UNF GR 5 Z	2	H2E
F11104-150	HCS 1/2 x 2 UNF GR 5 Z	2	G1D
A00560-75C70	Hollow Rubber Spring	2	C12A
K10405-003	PF357 WELDMENT PAINTED	2	D12D
B90223	10-3/4 x 9-1/2 x 7 DW Carton	1	A1A
B10100	NEWSPRINT 18" ROLL	1	
B00029-010	BARCODE LABEL FOR KIT	1	

Issued: 7/11/2006

Clearance Instructions:

Rear SES Kits for Pick-Ups and Vans should have a 1/2" to 1-1/2" gap between the rubber spring and contact point when empty.

A partial load, or vehicle accessories will reduce or eliminate the gap.

Front SES kits are usually in full contact.

Medium and Heavy-Duty Trucks, Trailers and Motorhomes will be in constant contact, and have no gap.