

T-HANDLE INSERT TOOL

NOTICE: FOR THE TEMPORARY REPAIR OF TUBELESS TIRE PUNCTURES. THE GENERAL INDUSTRY STANDARD RECOMMENDS A COMBINATION PLUG AND INNER LINER PATCH TO BE CONSIDERED A PERMANENT REPAIR. PLEASE SEE A TIRE REPAIR PROFESSIONAL AS SOON AS POSSIBLE.

Instructions

1



2

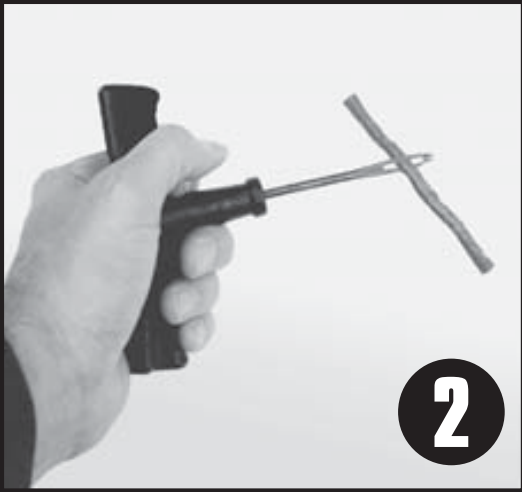

3



4

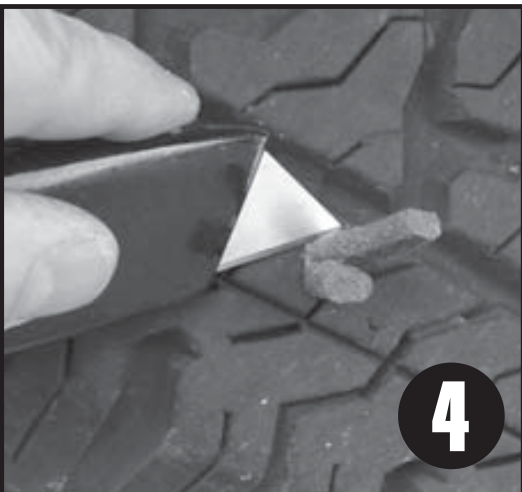

1. Remove object that caused puncture and insert rasp tool into hole, sliding up and down to clean inside of hole.
 2. Remove repair plug from backing material and insert into eye of needle tool. Center plug within eye opening. If you have difficulty inserting plug into eye it may be opened up slightly with a flat blade screwdriver.
 3. Insert needle with repair plug into hole until plug is pushed in approximately 2/3 of the way. Pull needle straight out, without twisting, in a rapid motion.
 4. Cut off excess plug material flush with tread of tire. Inflate tire to manufacturer's recommended pressure.
- * Rasp tool, tire repair plugs and rubber cement sold separately.

